

# 3901 N. ROXBORO STREET

DURHAM | NORTH CAROLINA



AVAILABLE  
FOR LEASE

## BUILDING SPECIFICATIONS

**TOTAL BUILDING SIZE:**  
± 26,046 SF

## TOTAL AVAILABLE SPACE:

SUITE 109: ± 1,800 SF  
SUITE 112: ± 1,343  
SUITE 103: ± 2,927  
SUITE 101: ± 3,855

**YEAR BUILT:**  
1988

**ASKING LEASE RATE:**  
\$20.00/SF, NNN

**ELAINE BOYLE**

d. 919-348-7943

elaine@FlagshipHP.com

## BUILDING SUMMARY

- Desirable one-story medical office building providing easy access for all patients
- Excellent visibility on highly traveled N. Roxboro Street corridor with close proximity to Duke Regional Hospital, Hwy 501, and Hwy 70
- Average Vehicles Per Day is over 9,000
- Common areas with Class A finishes
- Located in strong medical corridor
- Abundant parking
- Exterior signage

400 Ashville Ave Suite 340, Cary, NC 27518 | P. 704-442-0222 | F. 704-367-0196 | [www.FlagshipHP.com](http://www.FlagshipHP.com)

©2023 The information contained herein was obtained from sources believed reliable; however, Flagship Healthcare Properties makes no guarantees, warranties, or representations as to the completeness or accuracy thereof. The presentation of this property is submitted subject to errors, omissions, changes of price or conditions prior to sale or lease, or withdrawal without notice.

# FLOORPLAN

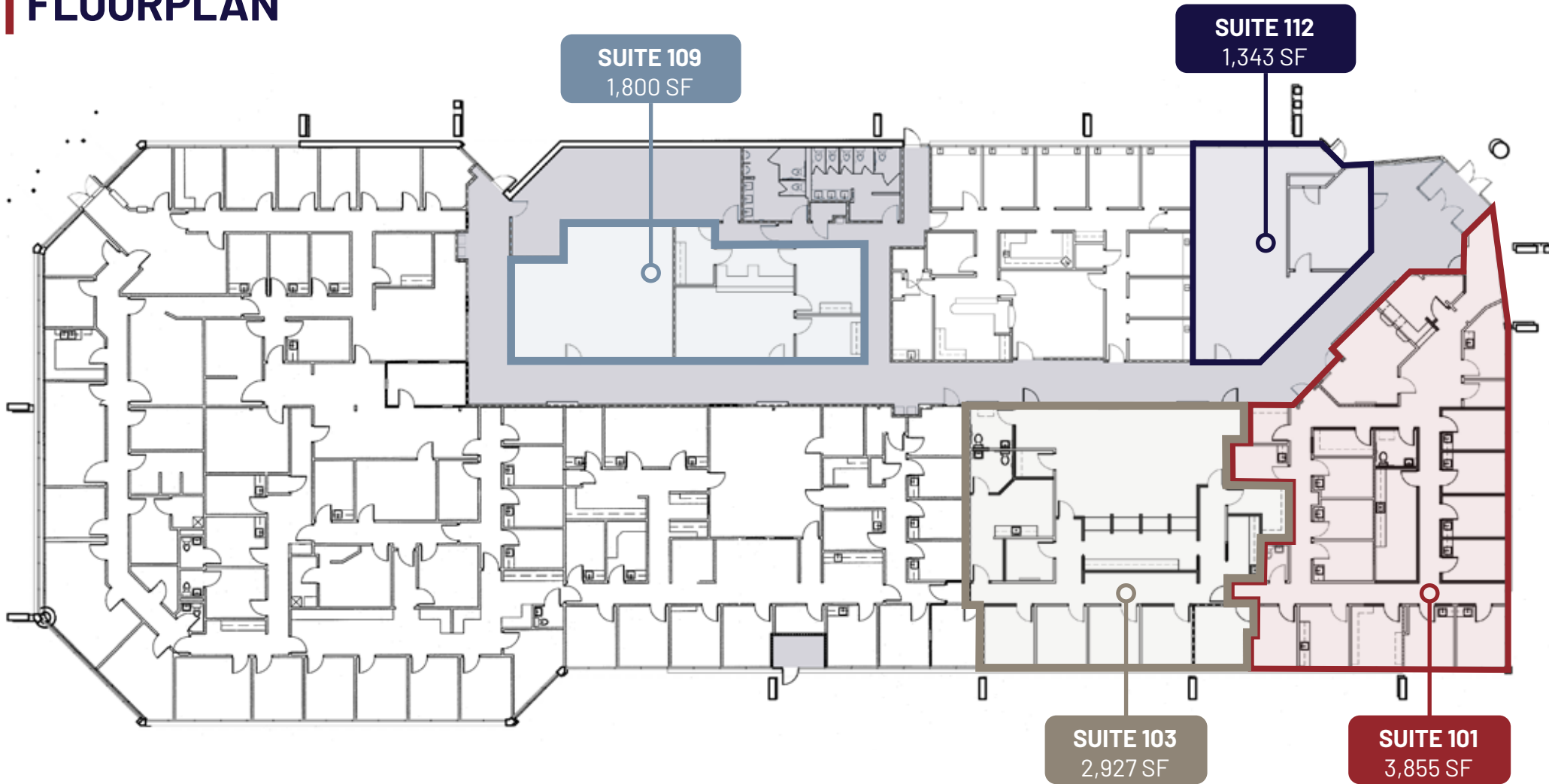

# AREA OVERVIEW

