

# JETTON MEDICAL PARK

Old Jetton Road | Cornelius, North Carolina 28031

AVAILABLE FOR LEASE



Jetton Medical Park is a Class "A" medical office park anchored by Lakeside Family Physicians. Featuring ample surface parking and abundant nearby amenities, this property is a prime opportunity for medical tenants.

## BUILDING SPECIFICATIONS

Total Building Area	± 45,000 SF
Total Available Space	± 2,705 SF
Year Built	2009
Asking Lease Rate	\$34.00/SF Full Service

### Reed Griffith

d. 704-971-8908  
reed@FlagshipHP.com

### Greg McIntosh

d. 704-562-2153  
greg@FlagshipHP.com

2701 Coltsgate Road, Suite 300 Charlotte, North Carolina 28211  
P. 704-442-0222 | F. 704-367-0196 | [www.FlagshipHP.com](http://www.FlagshipHP.com)

©2017 Flagship Healthcare Properties, LLC. All rights reserved. Information contained herein is from sources deemed reliable; however, no representation or warranty is made to the accuracy



**FLAGSHIP**  
HEALTHCARE PROPERTIES

# FLOORPLAN

SUITE 103 | 1,033 SF

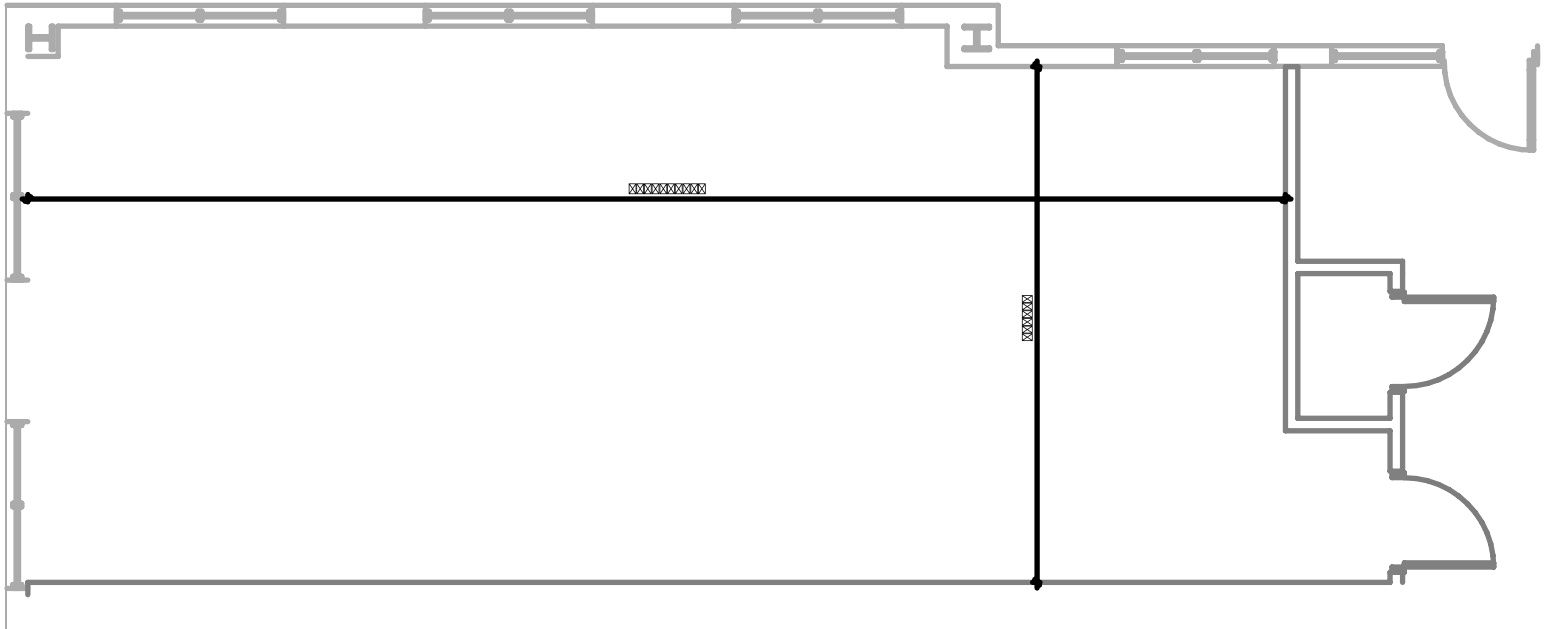

# FLOORPLAN

SUITE 200 | 1,672 SF

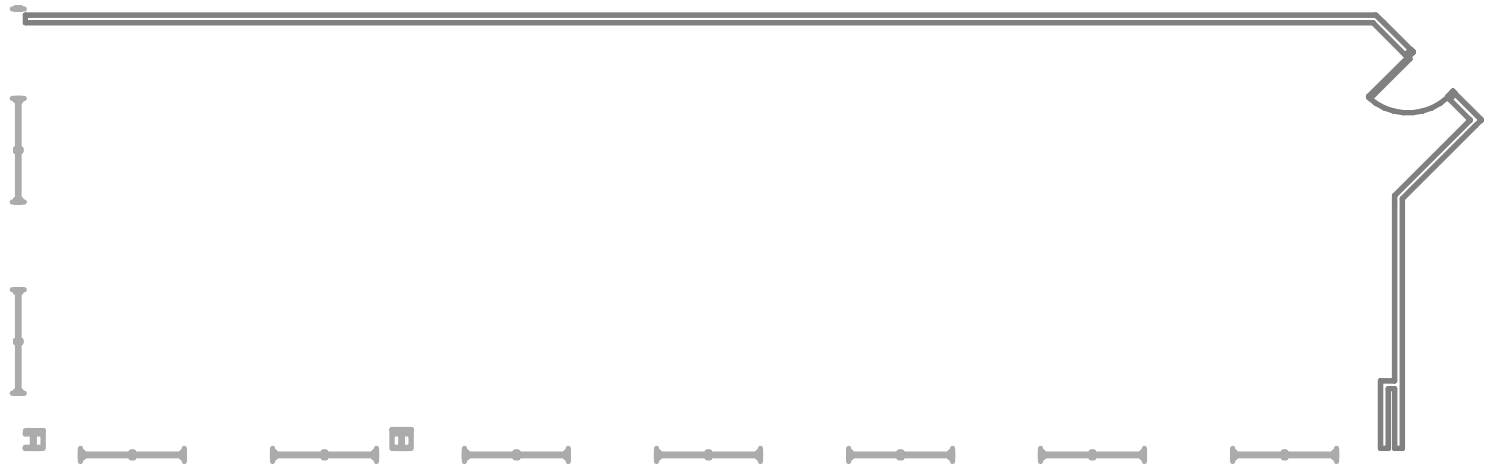



## LOCATION

Jetton Medical Park is conveniently located off Exit 28 approximately 1 mile from I-77 near the entrance to The Peninsula. This amenity rich corridor of the Cornelius submarket makes a beneficial location for tenants and their clients.

## AVAILABILITIES

### BUILDING ONE - 19475 OLD JETTON

Suite 200                      ± 1,672 SF                      Shell Condition

### BUILDING TWO - 19485 OLD JETTON ROAD

Suite 103                      ± 1,033 SF                      Shell Condition



**Reed Griffith**  
**d. 704-971-8908**  
**reed@FlagshipHP.com**

**Greg McIntosh**  
**d. 704-562-2153**  
**greg@FlagshipHP.com**

2701 Coltsgate Road, Suite 300 Charlotte, North Carolina 28211  
 P. 704-442-0222 | F. 704-367-0196 | www.FlagshipHP.com

©2017 Flagship Healthcare Properties, LLC. All rights reserved. Information contained herein is from sources deemed reliable; however, no representation or warranty is made to the accuracy



**FLAGSHIP**  
**HEALTHCARE PROPERTIES**